

INTRASTACK™ 6016DSE

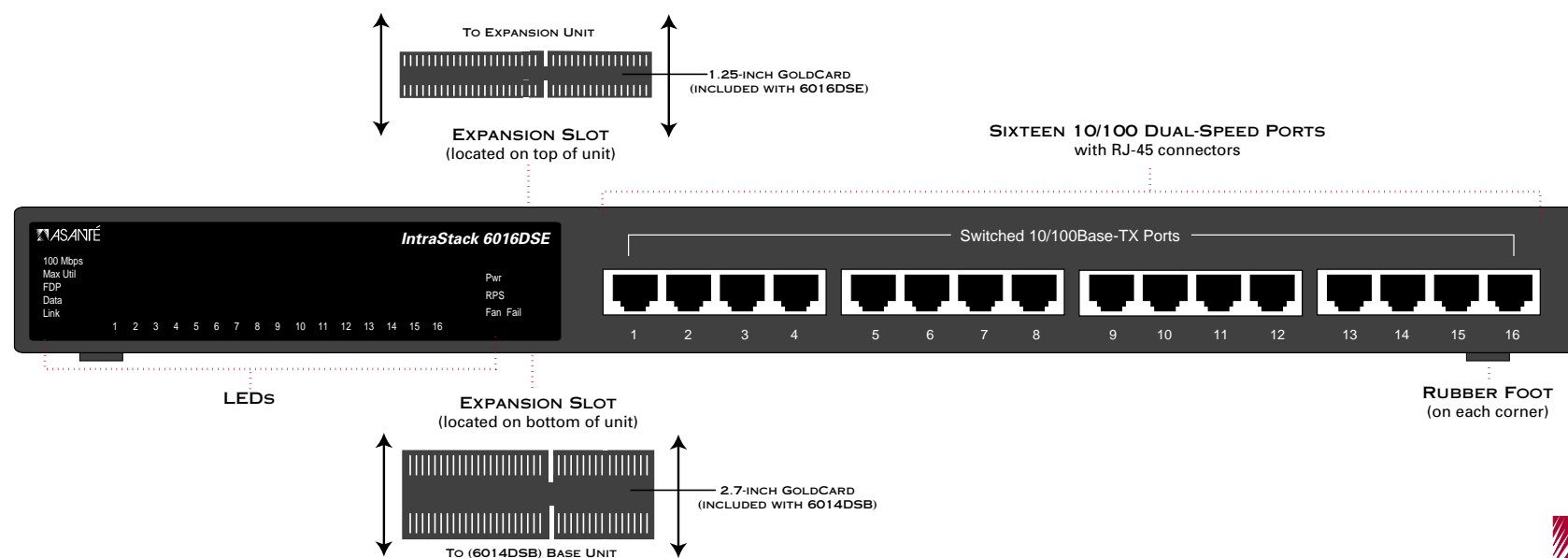

OVERVIEW

The Asanté IntraStack 6016DSE is a 16 port 10/100 dual-speed expansion unit for the IntraStack 6014DSB Ethernet switch.

The IntraStack 6016DSE provides expansion to the 6014DSB base unit with 16 10/100 dual-speed ports. Each port is capable of running at 10Mbps or 100Mbps.

▲ **Important:** The IntraStack 6016DSE expansion unit is not a stand-alone switch; it must be connected to an IntraStack 6014DSB base unit in order to function.

This guide provides instructions for mounting, installing, and connecting your IntraStack 6016DSE. For information on managing the IntraStack 6016DSE or configuring one of its ports, refer to the **IntraStack 6014DSB User's Manual**.

PACKAGE CONTENTS

The IntraStack 6016DSE is shipped with the following items:

- | | |
|---------------------------------------|---|
| (1) IntraStack 6016DSE Expansion Unit | (3) Stack-mounting brackets |
| (1) GoldCard™ connector (1.25-inch) | (2) Rack-mounting brackets |
| (1) Power cord | (14) Standard Phillips screws (10/32 x .5") |
| (2) Stack-mounting pins | (1) Installation Guide (this card) |
| | (1) Registration card |

Additional materials required:

- Network cables — see step 6 "Connect Network Devices," to determine the type of cable(s) you will need to connect network devices to the IntraStack 6016DSE.
- Phillips screwdriver — for rack-mounting the IntraStack 6016DSE.

DEFAULT PORT SETTINGS

The IntraStack 6016DSE is shipped with the following default port configuration settings:

- Auto-Negotiation: enabled
- Spanning Tree: enabled

INSTALLATION GUIDE

1 PREPARE FOR RACK MOUNTING (IF NECESSARY)

If your IntraStack 6014DSB base unit is installed in an equipment rack, you must prepare the IntraStack 6016DSE for rack mounting by installing the two rack-mounting brackets (included in this package) on the 6016DSE.

For example, if you are installing the 6016DSE onto an IntraStack 6014DSB base unit that is installed in an equipment rack, mount the two rack-mounting brackets on the IntraStack 6016DSE, then install the 6016DSE onto the 6014DSB base unit (while the base unit remains in the equipment rack).

If your IntraStack 6014DSB base unit is not installed in an equipment rack, make sure it is placed on a stable, horizontal surface with support capabilities of 21.5 pounds (9.7 kilograms) (31 pounds [14 kilograms] for a full stack of 3 units).

INSTALL RACK-MOUNTING BRACKETS

To install the two rack-mounting brackets on the IntraStack 6016DSE:

1. Place the IntraStack 6016DSE on a flat, stable surface.
2. Locate a rack-mounting bracket (supplied) and place it over the mounting holes on one side of the unit, as shown below.

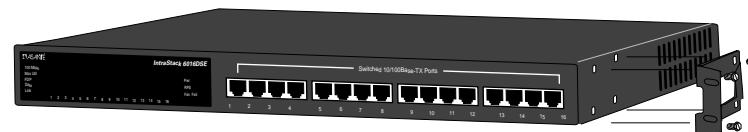

3. Insert four screws (supplied) into the holes and tighten with a Phillips screwdriver.
4. Repeat the two previous steps for the unit's other side.

The IntraStack 6016DSE is ready to be installed onto an IntraStack 6014DSB base unit in an equipment rack.

5. Proceed to Step 2, "Determine GoldCard Connector" to continue with the installation.

2 DETERMINE GOLDCARD CONNECTOR

The IntraStack's stackable design uses Asanté's GoldCard connector technology to expand the switching system via a 2Gbps PCI backplane connector.

Up to two expansion units can be added to the **top** of an IntraStack 6014DSB base unit, for a total of three units in a stack.

▲ **Important:** IntraStack expansion units, such as the 6016DSE and 6008FXE, must be installed on **top** of an IntraStack 6014DSB base unit or on top of another expansion unit.

Depending upon the placement of the IntraStack 6016DSE in the IntraStack switching system — either on top of the 6014DSB base unit or on top of another expansion unit — you may need to use the **2.7-inch GoldCard connector** included with the IntraStack 6014DSB base unit or the **1.25-inch GoldCard connector** included with the 6016DSE expansion unit.

INSTALLING ON TOP OF THE 6014DSB BASE UNIT

If you are installing the IntraStack 6016DSE directly on top of a 6014DSB base unit:

- Use the **2.7-inch GoldCard connector** included with the IntraStack 6014DSB.

▲ **Important:** Do **not** install the 1.25-inch GoldCard connector included in this package into an IntraStack 6014DSB base unit.

INSTALLING ON TOP OF ANOTHER EXPANSION UNIT

If you are installing the IntraStack 6016DSE on top of another expansion unit:

- Use the **1.25-inch GoldCard connector** included in this package.

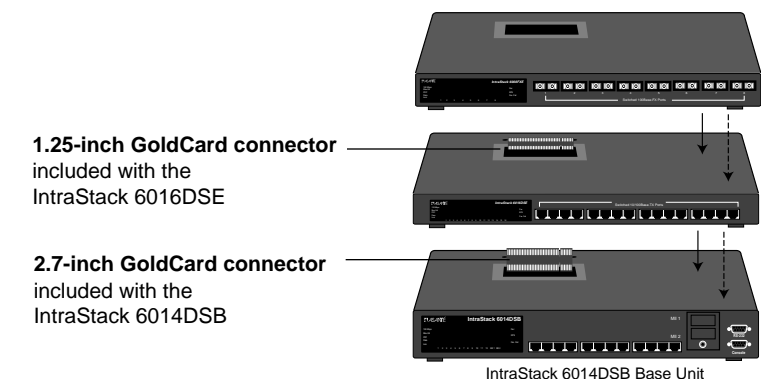

3 INSTALL THE INTRASTACK 6016DSE

The IntraStack 6016DSE can be installed onto an IntraStack 6014DSB base unit (or onto another expansion unit) while the unit is installed in an equipment rack.

To install the IntraStack 6016DSE expansion unit:

Note: These instructions pertain to installing the 6016DSE onto an IntraStack 6014DSB base unit or onto another expansion unit; however, as an example, the IntraStack 6016DSE will be installed directly on top of an IntraStack 6014DSB in these instructions.

1. Make sure all IntraStack units are powered off.
2. Make sure the IntraStack 6014DSB base unit is on a flat, stable surface or is properly installed in an equipment rack.
3. Remove the protective covering from the top of the IntraStack 6014DSB base unit to expose its expansion slot.

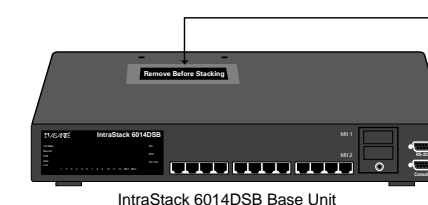

Expansion Slot
remove protective covering; do not remove the two EMI gasket strips (these strips are parallel with the expansion slot)

INSTALL THE INTRASTACK 6016DSE (CONTINUED)

- Insert the **2.7-inch GoldCard** connector into the 6014DSB base unit's expansion slot.
If you are installing the 6016DSE on top of another expansion unit, insert the 1.25-inch GoldCard connector into the expansion unit's slot.

▲ **Important:** For more information on Goldcard connectors, see step 2, "Determine GoldCard Connector."

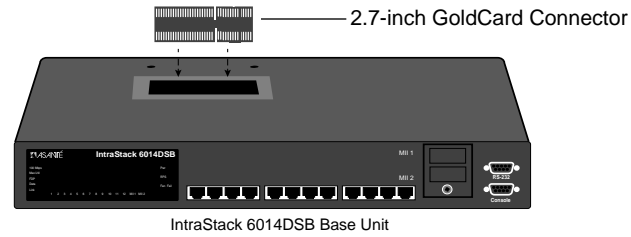

- Press firmly into place.
- Screw the two stack-mounting pins (included with the 6016DSE) into the holes on top of the IntraStack 6014DSB base unit.

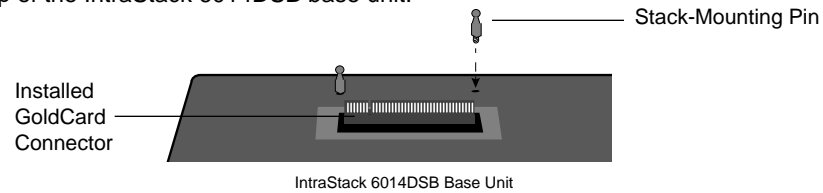

The stack-mounting pins help align and secure the IntraStack 6016DSE to the IntraStack 6014DSB base unit.

- Take the IntraStack 6016DSE and remove the label from the bottom of the unit to expose its slot.
- Carefully place the IntraStack 6016DSE on top of the IntraStack 6014DSB base unit, ensuring that the 6016DSE is aligned with the stack-mounting pins and that the GoldCard connector is properly fitted in the slots.

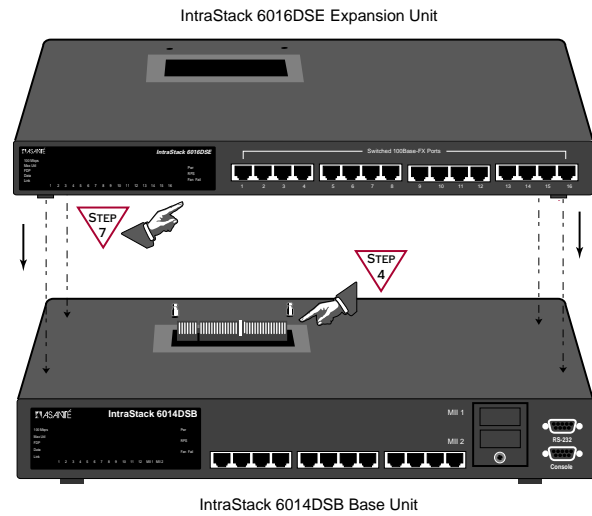

- Press firmly into place.
The installation of the IntraStack 6016DSE is complete.

If the IntraStack system is in an equipment rack, secure the IntraStack 6016DSE to the equipment rack, following the instructions in step 4, "Securing to an Equipment Rack."

If the IntraStack system is placed on a desktop, follow the instructions in step 4, "Preparing for Desktop Placement."

4 SECURE TO EQUIPMENT RACK OR PREPARE FOR DESKTOP PLACEMENT

SECURING TO AN EQUIPMENT RACK

If your IntraStack switching system is installed in an equipment rack, secure the IntraStack 6016DSE to the equipment rack following the instructions below.

- Screw the IntraStack 6016DSE's two installed rack-mounting brackets to the equipment rack.

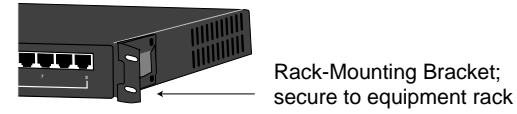

- Screw one stack-mounting bracket (supplied) to the back of the two units.
Note: The 6016DSE comes with three stack-mounting brackets; only one is needed to secure the unit when it is installed in an equipment rack.

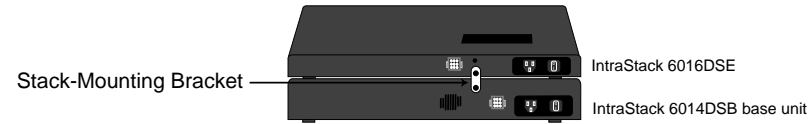

PREPARING FOR DESKTOP PLACEMENT

If your IntraStack switching system is placed on a desktop, secure the three stack-mounting brackets to the IntraStack 6016DSE and to the unit to which it is mounted.

- Screw one stack-mounting bracket (supplied) to the back of the two units (see the illustration above).
- Screw the two remaining stack-mounting brackets to the sides of the two units.

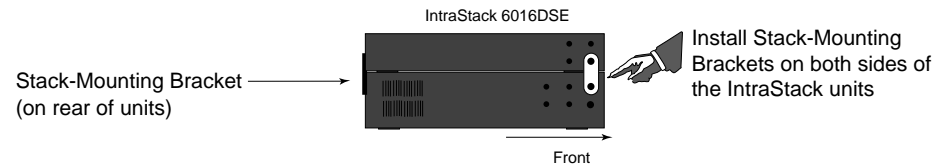

5 CONNECT POWER

To connect the IntraStack 6016DSE's power cord:

- Plug one end of the supplied power cord into the power connector on the back of the IntraStack 6016DSE; plug the other end into an AC outlet.
- Do **not** power on the IntraStack 6016DSE until you review the power-on sequence described below.

POWER-ON SEQUENCE

- Power on the expansion unit(s) **first**.
- Power on the IntraStack 6014DSB base unit **last**.

POWER-OFF SEQUENCE

- Power off the expansion unit(s) **first**.
- Power off the IntraStack 6014DSB base unit **last**.

▲ **Important:** An IntraStack system will not function properly if an expansion unit is powered off within the stack while the other unit(s) remain powered on.

6 CONNECT NETWORK DEVICES

You can connect 10Base-T or 100Base-T network devices to any of the IntraStack 6016DSE's 16 10/100 dual-speed ports.

DEVICE

- Network Station
- Repeater/Hub
- Repeater/Hub's UPLINK port

CABLE REQUIRED (100 METERS MAX.)

- Category 5 UTP **cross-over** cable with RJ-45 connectors.
- Category 5 UTP **straight-through** cable with RJ-45 connectors.
- Category 5 UTP **cross-over** cable with RJ-45 connectors.

REDUNDANT POWER SUPPLY

The IntraStack 6016DSE has a redundant power supply connector (located on the unit's back panel) that can be used to connect to an external Asanté RPSU 6000 redundant power supply unit (sold separately).

The RPSU 6000 provides the IntraStack 6016DSE with power in the event that the 6016DSE's main power connection fails. Refer to the RPSU 6000's Installation Guide for more information.

LED INDICATORS

LED	Color	Meaning
Power	green	The IntraStack 6016DSE is receiving electrical power.
RPS	amber	The IntraStack 6016DSE's connection to its internal power supply has failed and the unit is using the redundant power supply (if connected).
Fan Fail	amber	One, or possibly both, of the IntraStack 6016DSE's internal fans has failed.
Max Util	amber	The port's receive buffer is full (maximum utilization). Note: It is normal to see these LEDs illuminate during extremely high periods of network activity.
FDP	amber	The port is operating in full duplex mode. Note: The duplex mode for a port is set via the IntraStack 6014DSB's software. See the IntraStack 6014DSB's User's Manual for instructions.
Data	green	Traffic activity is occurring on a port (transmit [TX] or receive [RX]).
Link	green	A node or other network device is properly connected to the port.

TECHNICAL SPECIFICATIONS

Dimensions	17.1" x 14.5" x 1.75" (434.3 x 368.3 x 44.5 mm)
Weight	9.5 lbs. (4.3 kg.)
Power Specifications	Voltage Range: 100 - 240 VAC Frequency: 50/60 Hz Max. Input Current: 1.0 A (RMS) @ 115 VAC
Environment	Temperature: 0° to 40° C; Relative Humidity: 5% to 85% non-condensing
Standards Compliance	Safety: UL, CSA, VDE, TUV Emissions: FCC Class A, EN55022, CE Class B
Redundant Power Supply	Asanté RPSU 6000 (part number 99-00454-07)

ASKING FOR ASSISTANCE

Telephone	(800) 622-7464	AppleLink mail/BBS	ASANTE
Fax	(408) 432-6018	FTP Archive	ftp.asante.com
Fax-Back	(800) 741-8607	Internet mail	support@asante.com
Bulletin Board Service (BBS)	(408) 432-1416	World Wide Web Site	http://www.asante.com
ARA BBS (guest login)	(408) 432-1416		

Technical Support Hours: 6:00 A.M. to 5:00 P.M. Pacific Standard Time, Monday-Friday
For troubleshooting tips, refer to Appendix A in the **IntraStack 6014DSB User's Manual**.

Copyright 1997 by Asanté Technologies, Inc.

All rights reserved. No part of this guide or any associated artwork, software, product, design or design concept, may be copied, reproduced or stored, in whole or in part, in any form, without the express written consent of Asanté Technologies, Inc. Printed in the United States of America.

Asanté, IntraStack, and GoldCard are trademarks of Asanté Technologies, Inc. All other product names are trademarks or registered trademarks of their respective companies.

FCC Information

This equipment has been tested and found to comply with the limits for a Class A digital device, pursuant to Part 15 of the FCC Rules. These limits are designed to provide reasonable protection against harmful interference when the equipment is operated in a commercial environment. This equipment generates, uses, and can radiate radio frequency energy, and, if not installed and used in accordance with the instructions, may cause harmful interference to radio communications. Operation of this equipment in a residential area is likely to cause harmful interference, in which case, you must correct the interference at your own expense.

Product Warranty

This IntraStack 6016DSE has a three-year warranty which applies to the original purchaser of the product. Asanté Technologies, Inc. warrants that this product will be free from defects in title, materials, and manufacturing workmanship during the warranty period. If the IntraStack 6016DSE is found to be defective, then, as your sole remedy and the manufacturer's only responsibility, Asanté Technologies, Inc. will repair or replace the product. This warranty does not apply to IntraStack 6016DSE products that have been subject to abuse, misuse, abnormal electrical or environmental conditions, or any condition other than what can be considered normal use. The warranty card must be filed with Asanté Technologies, Inc. within 30 days after the date of purchase.

Warranty Disclaimers

Asanté Technologies, Inc. makes no other warranties, express, implied, or otherwise, regarding the IntraStack 6016DSE, and specifically disclaims any warranty for merchantability or fitness for a particular purpose. The exclusion of implied warranties is not permitted in some states and exclusions specified herein may not apply to you. This warranty provides you with specific legal rights. There may be other rights you have which vary from state to state.

The liability of Asanté Technologies, Inc. arising from this warranty and sale shall be limited to a refund of the purchase price. In no event shall Asanté Technologies, Inc. be liable for costs of procurement or substitute products or services, or for any lost profits, or for any consequential, incidental, direct damages, however caused and on any theory of liability, arising from this warranty and sale. These limitations shall apply notwithstanding any failure of essential purpose of any limited remedy.